

SHEET 1

PENANG SANGAM HIGH SCHOOL

YEAR 10

BASIC TECHNOLOGY

WORKSHEET – 2

QUESTION 1

MULTIPLE CHOICE

(8 marks)

1. Which of the following is a principle of design?

- A. Variety
- B. Rhythm
- C. Alignment
- D. Aesthetics

2. Safety goggles should be used when a student needs to

- A. Sharpen a carving tool
- B. Chip off wood using chisel
- C. Cut the stencil for screen printing
- D. Have a clear vision in the workshop

3. Continuous ruled thick line is called

- A. Break line
- B. Visible line
- C. Reference line
- D. Construction line

4. Which of the following gives the correct order of the Basic Design Cycle for the production of a table?

- A. brief, situation, investigation, evaluation, presentation
- B. investigation, brief, situation, evaluation, presentation
- C. situation, brief, investigation, evaluation, presentation
- D. situation, investigation, brief, evaluation, presentation

5. To Quadrisection an arc is to

- A. Divide the arc into 4 equal parts
- B. Divide the arc into 3 equal parts
- C. Divide the arc into 2 equal parts
- D. Divide the arc into 5 equal parts

6. The symbol shown on the right represent a

- A. Earth
- B. Concrete
- C. Insulation
- D. Hardcorefil



7. **O.H.S** is an area concern with the

- A. Health
- B. Safety
- C. Welfare
- D. All the above.



8. The type of drawing instrument used to step off distances is called

- A. Ruler
- B. Divider
- C. Protractor
- D. Set square

QUESTION 2

GEOMETRICAL DRAWING

Given:

The orthographic view of a shaped block is given below in 3rd Angle Orthographic Projection.

Required

Taking the measurements directly from the views given below, draw the shaped block in oblique drawing to a scale of **1:2**, using the starting point O.

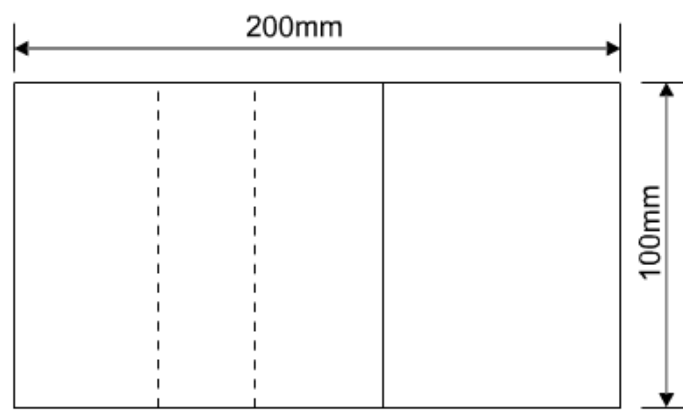

PLAN VIEW

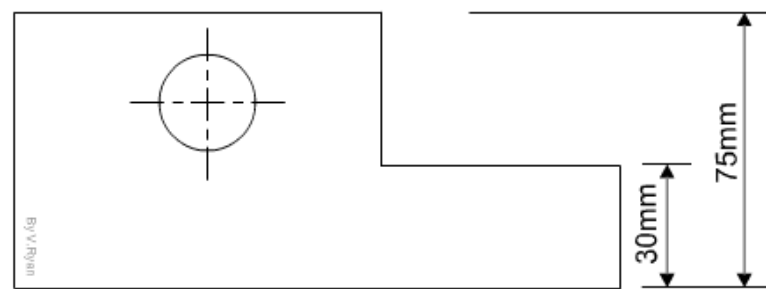

FRONT VIEW

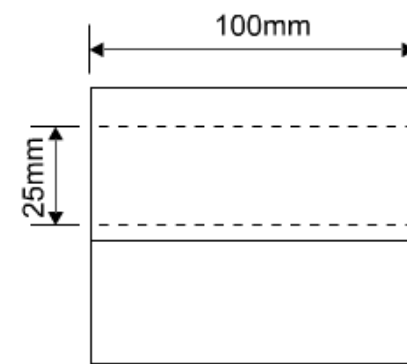

SIDE VIEW

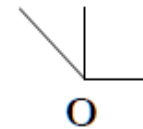

THE END