

1076 NADI SANGAM SCHOOL

YEAR 8

CONSOLIDATED

**WEEKLY HOME STUDY
PACKAGE:13**

2021

MULTIPLE CHOICE

1. Tom is to catch the school bus at quarter past seven. What would be the correct time on his digital watch?
- A. 7:30 B. 7:10 C. 7:45 D. 7:15
2. Luisa has a piece of land as shown in the diagram below.

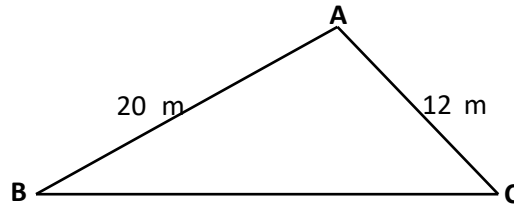

- If the perimeter of the land is 50 metres, what is the distance from **B** to **C**
- A. 38 m B. 18 m C. 32 m D. 28 m
3. How many **lines of symmetry** are there in this triangle?

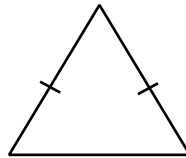

- A. 1 B. 2 C. 3 D. 4
4. What is the probability of getting a 2 when a dice is rolled?



- A. $\frac{1}{6}$ B. $\frac{2}{6}$ C. $\frac{4}{6}$ D. $\frac{6}{6}$
5. From a number x , I took away 10. I then multiplied the result by 3 and called the final answer y . If $y = 12$, the correct number sentence to solve for y is:
- A. $x - 10 \times 3 = 12$ B. $3x - 10 = 12$
 C. $3(x - 10) = 12$ D. $\frac{(x - 10)}{3} = 12$
6. The deposit on a \$350 guitar is 50%. How much is the deposit?
- A. \$7 B. \$35 C. \$175 D. \$700
7. Mereoni was given \$5.00 for her spending. She spent \$3.00 on snacks. What percentage of the money was spent on snacks?
- A. 2% B. 40%
 C. 3% D. 60%

8. Francis's age is x years and her mother is 25 years older.
Which number sentence gives the age of Francis's mother in years?

A. $x - 25$ B. $x + 25$
C. $x \times 25$ D. $x/25$

9. Mother baked a cake. Jim ate $\frac{2}{8}$ and John had some too. $\frac{1}{2}$ of the cake was left. What fraction of the cake did John have?

A. $\frac{3}{10}$ B. $\frac{6}{8}$
C. $\frac{1}{4}$ D. $\frac{1}{2}$

10. Shaveet made the following wooden fence.

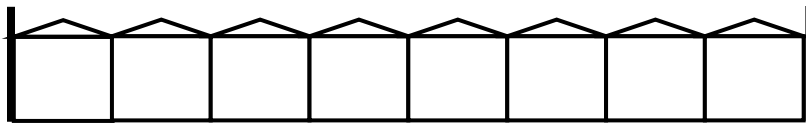

He painted half of the fence and his brother painted one piece only.
What fraction is not painted?

A. $\frac{4}{8}$ B. $\frac{1}{8}$ C. $\frac{5}{8}$ D. $\frac{3}{8}$

11. A juice company delivers 344 cartons of juice each day. How many cartons does it deliver in 4 days?

A. 86 B. 340 C. 348 D. 1 376

12. Jasmita had \$50. She went to the market and bought carrots for \$5.00, cabbages for \$3.50, a bundle of dalo for \$13.00 and tomatoes for \$3.00. Her taxi fare was \$6.70. How much did she have when she got home?

A. \$18.80 B. \$24.50
C. \$31.20 D. \$43.50

- 13.



Distance = 9 km

Astha leaves home at 6.30 am and reaches the store at 9.30 am. Calculate her average walking speed.

A. 3 km/hr B. 12 km/hr
C. 6 km/hr D. 27 km/hr

14. Look at the pictures below.

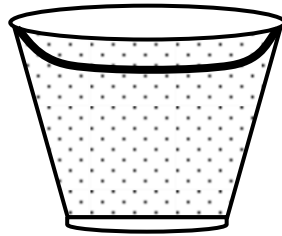

10 l bucket of juice



2 l jug

How many jugs of juice will you fill from the 10 l bucket of juice?

- A. 20 B. 10 C. 5 D. 2
15. The length of a pencil is 5 cm. It takes 2 pencils to measure the length of the book as shown in the diagram.

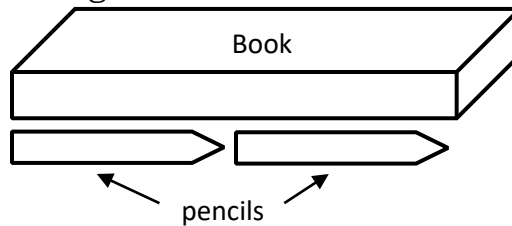

What is the length of the book?

- A. 2 cm B. 5 cm C. 7 cm D. 10 cm
16. Jale's birthday is on the 3rd of February.

January

S	M	T	W	TH	F	S
	1	2	3	4	5	6
7	8	9	10	11	12	13
14	15	16	17	18	19	20
21	22	23	24	25	26	27
28	29	30	31			

On what day will Jale be celebrating his birthday?

- A. Thursday B. Friday C. Saturday D. Sunday
17. Andrew drew a triangular prism as shown below.

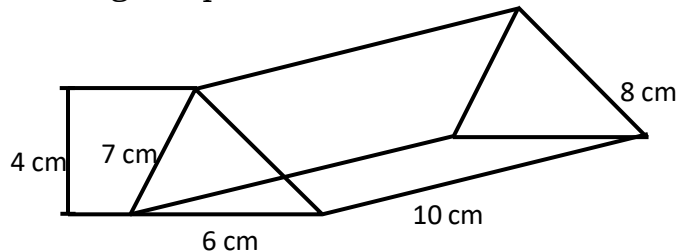

What is the total surface area of the triangular prism?

A. 12 cm

B. 35 cm

C. 222 cm²

D. 234 cm²

18. A rectangular garden is shown below.

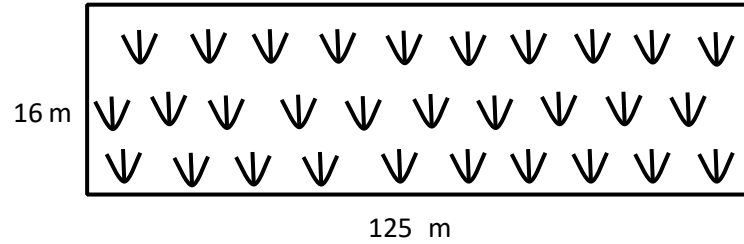

What is the area of this garden?

A. 2 000 m²

B. 3 000 m

C. 141 m²

D. 241 m

- 19.

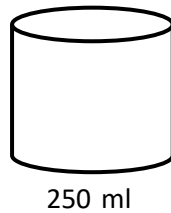

How many 250 ml containers of water are needed to fill up the larger container?

A. 2

B. 4

C. 6

D. 8

20. Rusiata wants to paint the roof of his house. How many litres of paint will he need if 1 litre covers 15 m²?

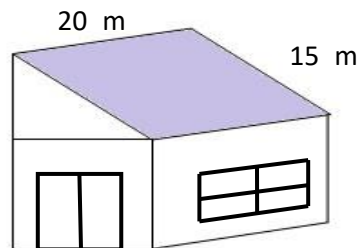

A. 10 litres

B. 20 litres

C. 30 litres

D. 300 litres

1076 NADI SANGAM SCHOOL
YEAR 8 – 2021
ENGLISH WEEKLY HOME STUDY PACKAGE 13

1. Which word is spelt correctly?
A. epedemic B. epidemic C. epydemic D. epidmic
2. Choose the correct spelling of the word that will complete the sentence below.
Animals have _____ ears.
A. sensative B. sensitive C. sensetive D. sencitive
3. Which list of words is in alphabetical order?
A. spilling, shoulder, simple, sack
B. sack, spilling, shoulder, simple
C. sack, shoulder, simple, spilling
D. shoulder, simple, spilling, sack
4. Which word is a **proper noun** in this sentence?
Every day Kira comes to school by car.
A. Every B. Kira C. school D. car
5. Choose the correct word to fill in the blank.
_____ glass of milk daily is a good source of vitamins and minerals.
A. An B. A C. The D. Two
6. What is the plural form of the underlined word below?
Jeena bought a knife from the shop.
A. knifes B. knives C. knife's D. knivs
7. Choose the correct preposition to complete the sentence
I have been waiting for the doctor _____ 9 o'clock.
A. at B. before C. since D. until
8. Choose the correct word to fill in the blank.
The oil slick spread very _____.
A. quick B. quicker C. quickly D. quickest
9. Which word correctly completes the sentence?
The Head Teacher comes to school _____ than most of the staff.
A. early B. earlier C. earliest D. most early
10. Choose the correct word to fill in the blank.
We finished the cleaning _____.
A. herself B. himself C. themselves D. ourselves

[illegible]

1076 NADI SANGAM SCHOOL
YEAR 8 – 2021
WEEKLY HOME STUDY PACKAGE 13
BASIC SCIENCE – LESSON NOTES

Content Learning Outcome – Gather information about the uses of different layers of the atmosphere and describe the human action on these.

Layers of the Atmosphere

Draw and Color the different layers of the atmosphere



HINT: (TSMTE)

Characteristics of each Layer

1. TROPOSPHERE

- Home layer – layer of the atmosphere around us and most disturbed layer because all weather changes occurs here.
- Gaseous component – 75% of all atmospheric air ,heaviest air level and high air pressure.
- 75% Nitrogen, 21% Oxygen,1% Argon, carbon dioxide and other gases.

2. STRATOSPHERE

- Where airplanes fly
- Contains the ozone layer and temperature rises with increasing altitude.(due to absorption of ultra violet rays of the sun by the ozone layer)
- Almost free of clouds and other forms of weather.

3. MESOSPHERE

- Hot air balloon fly to detect weather
- Air is thin and cold
- Temperature drops as altitude increases
- Most meteors fall from outer space burns upon atmospheric entrance
- Can only be accessed by rocket powered jets or aircrafts and powered satellites and orbital space crafts.

4. THERMOSPHERE

- Solar UV radiation is very high; temperature depends on solar activity
- Radiation causes this atmosphere to be electrically charged, enabling radio waves to bounce off and received beyond the horizon
- Air space is nearly zero – not enough to transfer heat.
- Space shuttle and International Space Station of NASA can be found.

5. EXOSPHERE

- Atoms and molecules are far apart – no longer behave like a gas
- Contains low densities of hydrogen helium and other molecules of nitrogen, oxygen and carbon dioxide.
- Far beyond earth and Meteorological phenomena is impossible.
- Only high-powered satellites orbit the earth here.

Man's Activities in the Layers of the Atmosphere

- The troposphere is the atmosphere that is greatly disturbed

How is it Disturbed?

- Industrialization, technologies invention, burning of fossil fuels
- Emission of carbon monoxide and carbon dioxide have a serious effect on health and environment – result of combustion
- These gaseous compounds are found in chemicals, pesticides, in devices and motors at home.
- The excess amount of carbon monoxide and carbon dioxide contributes to more and more heat and thus our earth gets warmer than normal.
- The ozone layer gets depleted, allowing more UV rays to penetrate through.

Impact of Human Activities

- ❖ Human exposed to radiation which causes skin cancer, sickness and variety of health problems.
- ❖ Melting of ice in the poles
- ❖ Recession of glaciers on global scale
- ❖ Migration of temperature species
- ❖ Increasingly unpredictable weather and global temperature

Note

The concentration of carbon dioxide in the atmosphere can affect the ocean acidity growth patterns of all plant life and could affect maturation process of animals due to less content of relevant gases.

1076 NADI SANGAM SCHOOL
YEAR 8 HINDI WEEKLY HOME STUDY PACKAGE - 13

SECTION A

भाषा - LANGUAGE

अ.

1. नीता ----- घर के पास रहती है ।
क. मेरे ख. मेरा ग. मेरी घ. मैं
2. अतुल अपने कुत्ते ----- बहुत प्यार करता है ।
क. कि ख. की ग. को घ. पर
3. पिताजी ने गाय को हरी-हरी घास -----।
क. दी ख. दिया ग. दिए घ. देगा
4. रोज सबेरे ----- कतार में खड़े हो जाते हैं ।
क. बच्चा ख. बच्चे ग. बच्चो घ. बच्चों
5. उसे मालूम है कि तुम ----- से नाराज़ हो ।
क. वे ख. उस ग. वह घ. उन

आ.

इन शब्दों के पर्यावाची (synonyms) शब्द बताइए

6. लोभी-
क. लालची ख. चालाकी ग. सन्तोषी घ. विश्वासी
7. मनोहर-
क. बदसूरत ख. सुन्दर ग. सुशील घ. उजाला
8. सम्मान-
क. विरोध ख. चर्चा ग. पसन्द घ. आदर

इन शब्दों के विलोम (opposite) शब्द बताइए

9. उजाला-
क. बिजली ख. अंधेरा ग. आग घ. रेशनी
10. विजय-
क. अन्याय ख. जीत ग. हार घ. सफलता

ख.

इस मुहावरों को पूरा करो

11. सेवा बिना ----- नहीं ।

क. हलवा

ख. मेवा

ग. खोवा

घ. लोहा

12. अन्धा क्या चाहे, दो ----- ।

क. आँखें

ख. पाँव

ग. साँसे

घ. दाँते

13. जले पर ----- छिड़कना ।

क. रस

ख. पानी

ग. चीनी

घ. नमक

इन मुहावरों का सही अर्थ लिखो

14. आँख झपकना

क. आँसू आना

ख. इशारा करना

ग. नींद आना

घ. कुछ बताना

15. दुम दबाकर चल देना

क. कष्ट देना

ख. धोखा देना

ग. क्रोध करना

घ. चुपके से भाग जाना

ख.

वर्तनी को सुधार कर लिखो

16. दुनीया -----

17. जगहा -----

18. लाबदायक -----

19. पसनद -----

20. अराम -----

1076 NADI SANGAM SCHOOL
YEAR 8 – 2021
WEEKLY HOME PACKAGE STUDY 13
NA VEIKA VAKA VITI

WASEWASE B NA VOSA VAKA-VITI.

Sauma na taro.

Sa suru na belo.

1. Na vosa cava e nauni ena i yatu vosa e cake?

A. Sa C. belo B. na D. suru

2. Na vosa cava e tautauvata na kena i balebale kei na vosa e kata buto ena i yatu vosa e ra?

E qali ki Viti ko Rotuma.

A. vakarurugi C. vakateruya B. yautalatala D. vakalevukena

3. Na veibasai ni vosa na **buwawa** na

A. buto. B. rikou. C. matata. D. tuwawa.

4. Na yavu ni vosa ka a sucu mai kina na **vakatasosoko** na

A. soko. B. sosoko. C. bosoka. D. sokota.

5. **Sa dreu toka na kena leba e dau cavuti ni**

A. sa kunekune o Leba.

B. bale na marama ni vanua.

C. dua na soqo sa vakarautaki oti tu.

D. sa matua na leba ka sa rawa ni laukana.

6. Keimami a cabe bula kei rau na drua mai Nasilai.

Kevaka e vakaibalebaletaki ki na lewe dua na i yatu vosa e cake ka me kua ni wili kina o koya e vosa tiko e sa na

A. Au a cabe bula kei rau na drua mai Nasilai.

B. E a cabe bula kei rau na drua mai Nasilai.

C. Keirau a cabe bula kei na drua mai Nasilai.

D. Keimami a cabe bula kei rau na drua mai Nasilai.

7. Na Vula i Kelikeli e veidonui kei na

- A. Veverueri B. Janueri. C. Maji. D. Me.

8. “**Vakaturaga saka i Lalagavesi.**”

Na i cavuti oqo e cavu tiko vua na turaga na

- A. Tui Cakau. B. Vunivalu. C. Qaranivalu. D. Tui Macuata

9. Na i yatu vosa cava e volai ka vakadigotaki vakadodonu?

- A. “Mo dau vakarokoroko,” a vakasorokakana o Rasinu.
B. “Ko gole ni naica? e taroga o Buka. ”
C. “Ko sa kana se sega” a taroga o Miliana?
D. Sa kua so na wele, « a kaya ko Salome.

10. Na i vosavosa vaka-Viti cava e veiwekani kei na talisasanitaki ni ka me vavi?

- A. Botowalai B. Kana yarayara
C. Sa ukucavu tu D. Sa dravu na lovo

1076 NADI SANGAM SCHOOL
YEAR 8 HEALTHY LIVING WEEKLY HOME STUDY PACKAGE 12, 2021
ARTIFICIAL RESPIRATION

Achievement indicator: Participate in community-based wellness activities.

Study the picture below, read your notes on page 42 of your Healthy Living Year 8 textbook and attempt the questions below.



1. What should you do before you start artificial respiration?

2. Explain the 5 steps that you would take when applying artificial respiration. Provide illustrations to support your answers.

STEP 1	<hr/> <hr/> <hr/> <hr/> <hr/> <hr/> <hr/>
STEP 2	<hr/> <hr/> <hr/> <hr/> <hr/> <hr/> <hr/>

STEP 3

STEP 4

STEP 5

1076 NADI SANGAM SCHOOL
YEAR 8 SOCIAL SCIENCE WEEKLY HOME STUDY PACKAGE 13, 2021
PEOPLE AND CARE OF PLACES

Achievement Indicator.

Identify and collect evidence of some major world climatic issues

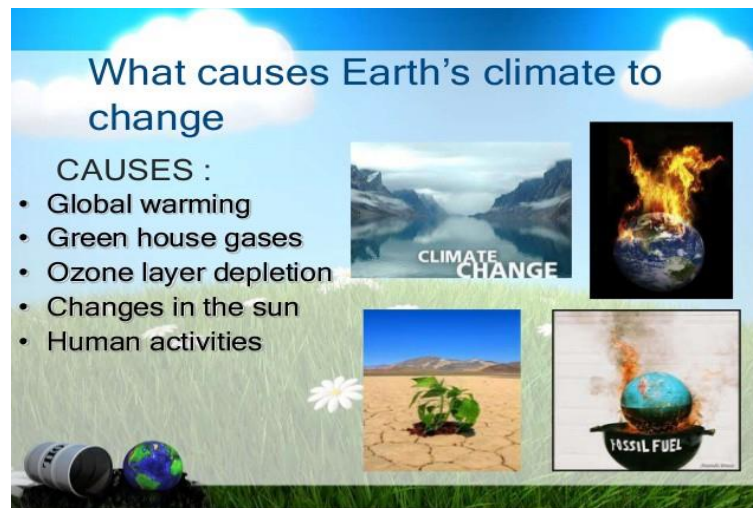

1. Define Global Warming

**Discuss some impacts of Global Warming on:
the environment.**

on humans:

2. Explain some causes of Global Warming
