

PENANG SANGAM HIGH SCHOOL

P.O.BOX 44, RAKIRAKI

WEEK 12 WORKSHEET

Subject: Technical Drawing

Year/Level: 12

Strand	TD 12.3 APPLIED DRAWING
Sub Strand	TD 12.3.1 ORTHOGRAPHIC PROJECTION
Content Learning Outcome	TD 12.3.1.1 Develop and draw simple electrical plans and assembled engineering sectional drawings.

LESSON NOTES

ELECTRICAL SYMBOLS

OUTCOME

By the end of this topic, students will:

- a) Identify and use electrical and building symbols and standards in electrical drawings.
- b) Draw an electrical plan and insert the correct electrical and building symbols at the appropriate locations.

INTRODUCTION

An electronic symbol is a pictogram used to represent various electrical and electronic devices (such as wires, batteries, resistors, and transistors) in a schematic diagram of an electrical or electronic circuit. These symbols can (because of remaining traditions) vary from country to country, but are used today to a large extent and internationally standardized. Some symbols represent components (such as vacuum tubes) which ceased to be used routinely as newer technologies were introduced.

ELECTRICAL SYMBOLS

Name	Symbol	Name	Symbol
One way switch		Switch - with dimmer	
Two way switch		Switch - intermediate	
Socket outlet		Switch - push button	
Switch socket outlet		Ceiling mounted light	
Window - In cavity wall		Wall mounted light	
Door - Swing single		Fluorescent lamp - general	
Door - Swing double		Spot light	
Door - Sliding into pocket		Flood light	

Door - Sliding exposed on wall		Distribution board	
Point of entry		Earth	
Sawn timber		Dressed timber	
Timber break		Insulation	
Concrete		Hardcore fill	

STUDENT ACTIVITY

Given: The Floor Plan of Balak's building with various symbols on it. Each symbol is denoted by a letter from **A** to **O**.
 Required: Name each symbol in the space provided.

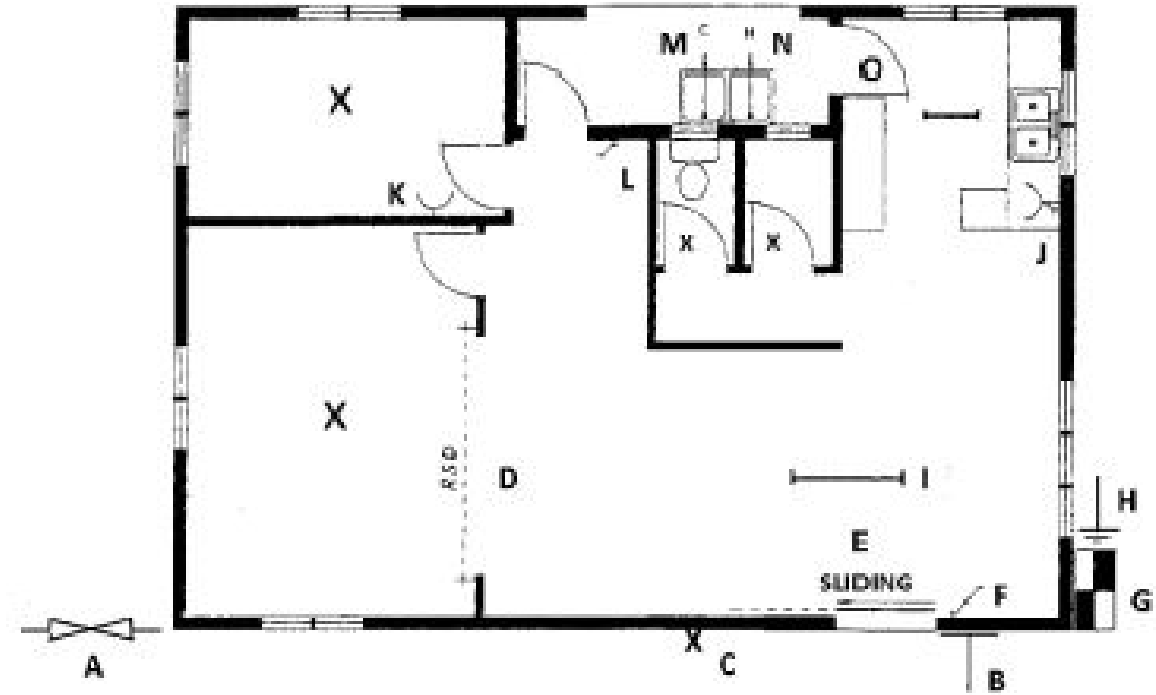

- A - _____
- B - _____
- C - _____
- D - _____
- E - _____
- F - _____
- G - _____
- H - _____
- I - _____
- J - _____
- K - _____
- L - _____
- M - _____
- N - _____
- O - _____

