

1076 NADI SANGAM SCHOOL
YEAR 8 ENGLISH LITERATURE
WORKSHEET 4 – 2021

SHORT STORIES

Rewrite on your English Literature under Short Stories Section

Title: The Turtle Nuts of the Vonu Tree

Setting : Nacamaki Village, Koro

Main Characters: Inquistive young man, The god

Other Characters: villagers

Plot / Summary

- Nacamaki village in Koro is known for turtle calling.
- On certain time of the year the whole village would make their way to the beach and would chant songs and clapped their hands until one by one turtles appear from the depth of the ocean and crawled to the shore
- The tradition was that as soon as the turtles appeared, the villagers would turn back and head back to their homes without looking back.
- During the next turtle calling, while others were busy singing and clapping hands, this young man hid in a safe place and slowly the turtles began to appear from all directions.
- While the other village people returned this young main remained hiding to see what was happening.
- All the turtles stood in a row facing towards the sea as if they were waiting for someone to arrive.
- Suddenly the young man could see a figure appearing from the sea but he could not figure it whether it's a man or turtle.
- It made his way towards him and questioned him as to why he had broken the scared law which was set by God.
- The man was so scared that he could not utter a single word from his mouth
- The God decided to punish the young man to teach him a lesson so he turned him into a tree
- When the young man failed to return the villagers were worried and on the 3rd day they went to search for him but he was never found instead the **Vonu Tree** with hard nuts was discovered.

Theme

- Over smartness can lead us into trouble
- Think of the consequences before doing something
- Don't break the rules just because of your curiosity

Question

1. According to the story , how did the young man break the forbidden rules of the gods
2. Where did he hide?
3. How was the young man punished for his mistake

1076 NADI SANGAM SCHOOL
YEAR 8 MATHEMATICS WORKSHEET 4 - 2021
REVISION

A. MULTIPLE CHOICE

1. Astha wrote the following statement on the board.
The product of diagonals divided by 2 gives the area of this quadrilateral.

The quadrilateral which Astha is referring to is

- | | |
|--------------|------------------|
| A. trapezium | B. parallelogram |
| C. rhombus | D. rectangle |
2. Johan bought a TV set for \$1450 from Courts Limited. He made a 10% deposit and decided to pay the rest as monthly payment. What amount is owed by Johan?
- | | |
|--------------|--------------|
| A. \$145.00 | B. \$1305.00 |
| C. \$1450.00 | D. \$1595.00 |

3. The roof of a building is shown below.

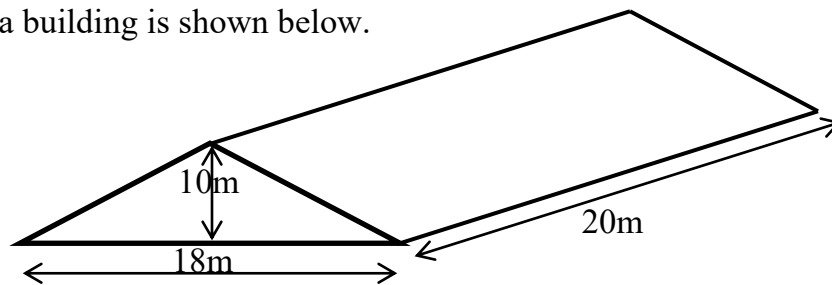

The volume of the roof is

- | | |
|-----------------------|-----------------------|
| A. 1800 m^3 | B. 1600 m^3 |
| C. 3600 m^3 | D. 560 m^3 |
4. 3^4 in expanded form will be
- | | |
|-----------------------------------|--------------------------|
| A. 3×4 | B. $4 \times 4 \times 4$ |
| C. $3 \times 3 \times 3 \times 3$ | D. $3 + 3 + 3 + 3$ |
5. The customary unit shown below is _____.



- | | |
|----------|-----------|
| A. cubit | B. fathom |
| C. span | D. pace |

B. SHORT ANSWERS

Show all necessary working.

a.) 2.37 pm in 24-hour clock will be = _____

b.) 2.35 m = _____ cm

c.) 102.78×100 equals

d.) Draw a rectangular prism.

e.) $\frac{175}{1000}$ in decimal is written as

f.) Name a 2-Dimensional figure.

g.) Find the area of a square with length 3.7 cm.

h.) List the prime numbers between 30 and 40.

i.) A cube has _____ faces.

j.) -9×4 equals

(10 marks)

STRAND 3 : ENERGY

Sub Strand : *Energy Transformation, Use and Conservation.*

Content Learning Outcome : *Students should be able to classify types of energy sources and state its uses, advantages and disadvantages*

Continue with the write up

TYPES OF ENERGY

- 1) Renewable (Replaceable)
- 2) Non- Renewable (Irreplaceable)

Renewable	Non – Renewable
<ul style="list-style-type: none">• Abundance in supply <p><u>Examples</u></p> <p><i>Solar</i> (Sun)</p> <p><i>Hydro</i> (Water)</p> <p><i>Wind</i></p> <p><i>Biomass</i> (wood, animal waste, aquatic plant, etc)</p> <p><i>Geothermal</i> (heat generated by natural process)</p>	<ul style="list-style-type: none">• Limited in supply <p>Examples</p> <p>Fossil fuels (coal, crude oil, gas)</p> <ul style="list-style-type: none">➤ Made from dead plants and animals➤ Coals are formed from fossil plants and are burnt to provide heat or electricity

Remember

- Burning of fossil fuels contribute or enhanced Greenhouse Effect

Note

- ❖ Electric current – flow of electricity through a wire
- ❖ Unit for electricity – Watts (W)

Energy Efficient Lights

1. Fluorescent Lights – e.g. tube lights (spiral)
2. Indescent Lights – Tube lights / Floodlights

Advantages and Disadvantages of Types of Energy

<i>Types of Energy</i>	<i>Advantage</i>	<i>Disadvantage</i>
Non – Renewable	<ul style="list-style-type: none">✓ Can be used to make something work✓ Readily available✓ Can separate fossil fuel to make another product✓ It is cheap and affordable by many	<ul style="list-style-type: none">○ Creates pollution○ Sometimes costly to buy○ Limited energy○ Cannot be replaced○ Produces acid rain
Renewable	<ul style="list-style-type: none">○ Free of supply○ Sun keeps life warmth for life to exist○ Pollution free○ Once installed – it is free of charge○ Noise pollution free	<ul style="list-style-type: none">✓ Expensive to install✓ Depends on the weather to function✓ Need many resources to install

Sub Strand : Forces

Content Learning Outcome : *Students should be able to investigate how different mediums such a soil , water , air affect the weight of mass of objects.*

Continue with notes write up.....

FORCES

- Force Meter – Measure force
- Bigger force is bigger stretch leads to bigger weight
- Unit of Force – Newton

Weight, Mass and Gravity

- ❖ Weight – caused by gravity , the weight of an object is the gravitational force between the object and the earth
- ❖ Mass – amount of matter – measured in kg, more matter – greater the mass
- ❖ Gravity – force that attracts

Note

Gravitational force increases when;

- The mass is bigger
- Objects are closer

$$1\text{KG} = 10\text{N}$$

Frictional Force

- Force acting in the opposite direction to the movements
- Forces are smaller on smooth surfaces than on rough surfaces
- When there is a lot of friction between moving parts, energy is lost as heat
- Air resistance is caused by frictional forces of the air against a moving object such as vehicle.
- Faster the vehicle , the bigger the air resistance
- Air resistance act against gravity

Note

Two forces acting on the fallen paper are;

1. Gravity (exerting force)
2. Air resistance (act against gravity)

1076 NADI SANGAM SCHOOL
YEAR 8 HEALTHY LIVING
WORKSHEET 4 – 2021

Review Questions Unit 16 – 25

1. What blocks artery?

1. Average temperature increase of the earth's surface is known as

2. Trapping of heat in the atmosphere which cause the earth's average etemperature to rise is known as _____ ?

3. What will higher temperature cause to water of the ocean and seas?

4. What is produced to generate electricity and to keep us warm?

5. What is produced by burning of fossil fuels like coal , oil and gas ?

6. Define recycle. Give example.

7. Define reduce? Give example.

8. Define reuse? Give example .

9. Clearing of forests in alarge scale is known as _____

10.

Complete the table below.

_State as many as you can

<u>Types of Disaster</u>	<u>Emotional Impact</u>	<u>Economic Impact</u>	<u>Physical Impact</u>	<u>Health Impact</u>
Cyclone				
Flood				
Accidents				

1076 NADI SANGAM SCHOOL
YEAR 8 HINDI WORKSHEET 4 - 2021

भाषा - Language

अ. प्रत्येक वाक्य के चार जवाब दिए गए हैं । सही जवाब चुनकर दिए गए वाक्यों को पूरा कीजिए । उत्तर - पुस्तिका में दिए गए स्थान पर सही जवाब के बगल वाले अक्षर पर गोलाकार निशान बनाइए ।

1. सुधा _____ पति बीमार है ।

- | | |
|-------|-------|
| क. की | ख. कि |
| ग. का | घ. को |

2. नदी पहाड़ से शुरू _____ है ।

- | | |
|---------|---------|
| क. होती | ख. होनी |
| ग. होता | घ. होने |

3. सुमन की पुस्तक फट _____ है ।

- | | |
|--------|--------|
| क. गया | ख. गई |
| ग. गए | घ. गयो |

4. यह सड़क बहुत _____ है ।

- | | |
|----------|----------|
| क. अच्छा | ख. अच्छे |
| ग. अच्छो | घ. अच्छी |

5. वे बच्चे अधिक शोर _____ हैं ।

- | | |
|----------|----------|
| क. मचाते | ख. मचातो |
| ग. मचाती | घ. मचानी |

आ. इन शब्दों के पर्यायवाची (synonyms) शब्द लिखो ।

6. संसार

- | | |
|-----------|---------|
| क. गगन | ख. जीवन |
| ग. दुनिया | घ. धरती |

7. घर

- | | |
|---------|----------|
| क. मकान | ख. माफ |
| ग. आदर | घ. बढ़ाई |

8. स्नेह
क. जलन
ग. गुस्सा
ख. प्रेम
घ. नाराज

9. हवा
क. नारी
ग. रजनी
ख. पवन
घ. दल

10. उजाला
क. कामना
ग. उल्लास
ख. नयन
घ. प्रकाश

इ. इन कहावतों / मुहावरों को दिए गए शब्दों में से सही शब्द को चुनकर पूरा कीजिए। उत्तर - पुस्तिका में दिए गए स्थान पर सही जवाब के बगल वाले अक्षर पर गोलाकार निशान बनाइए।

11. नाच न जाने _____ टेढ़ा।
क. गाँव
ग. आँगन
ख. कमरा
घ. दुनिया

10. जिस थाली में खाना उसी में _____ करना।
क. छेद
ग. स्नान
ख. मार
घ. लड़ाई

13. जो गरजते हैं, सो _____ नहीं।
क. डरते
ग. हँसते
ख. मरते
घ. बरसते

इन मुहावरों का सही अर्थ बतलाइए।

14. कान भरना
क. तंग करना
ग. शिकायत करना
ख. संकेत करना
घ. इज़्जत करना

15. अक्ल देना
क. बेवकूफ
ग. होशियार
ख. समझाना
घ. डींग हाँकना

(अंक 5)

1076 NADI SANGAM SCHOOL
SOCIAL SCIENCE YEAR 8
WORKSHEET NO.4, 2021

HOW TO USE MONEY WISELY

SPENDING BASICS

1) CREATE A BUDGET

- Organize your purchases by category (food, clothing, entertainment, etc)

2) PLAN YOUR PURCHASE / BUYING IN ADVANCE

- Write down what you need to buy while you're calm and at home.

3) AVOID IMPULSE PURCHASE

- Don't browse store windows or shop for fun. If you're only buying something because you find the act of shopping fun, you'll likely to end up spending too much on stuff you don't need.
- Don't make decisions when your judgment is impaired. Alcohol, drugs or sleep deprivation can harm your ability to make sensible decisions.

4) SHOP ALONE

- Do not take advice from store employees.

5) PAY IN FULL AND IN CASH

- Withdraw your weekly budget from an ATM once a week rather than filling up your wallet whenever you run out.

6) DON'T BE FOOLED BY MARKETING

- Don't purchase something just because it's reduced price

7) Wait for sales and discount

8) Do your research

9) Take all the costs into account

10) Compile a weekly menu and shopping list

11) Minimize eating at restaurants



ACTIVITY

1. Draw up your family budget for a week
2. Plan a week's menu together with the cost for your family
3. Give some advantages of budgeting your money
4. Do your parents/guardians plan a budget for your family?

**1076 NADI SANGAM SCHOOL
VEIKA VAKAVITI YABAKI 8
WORKSHEET NO.4, 2021**

NA VEIVOSA ME NANUMI

- a. Voravora – kaukauwa ka levu na kena leqa
- b. Yatusorosorotaka – yatuna me veituituitaki
- c. Vakawale gusu – vosataki se vakavulici vakawasoma
- d. Veivakamenemenei – na veika me vakaraitaka na loloma kei na veinanumi levu
- e. Vakavaletaki – ni sa la'ki tiko vakawati se vakamau e dua na yalewa
- f. I sakisaki – matau ka dau cibitaki
- g. Qevaka – kelivaka wavoki

NA I VOSAVOSA VAKAVITI

- a. Na I coricori ni salusalu – na I tavi vakaveiganeni nei yalewa me coria e dua na salusalu nei na ganena ni caka e dua na soqo se solevu.
- b. Na ucu ni vatu na kena vivili – e dua na ka eda vinakata vakalevu ka kena rawa ni da mavoia ni da saga yani.
- c. Tawa madaga na nomudou dela ni yavu – oqo na masu vakavanua e na veicabocabori e na solevu ni vakamau se dua tale na veiqaravi. Me tubu na kawa.
- d. Na katikati – na vosa vakavanua ni veiwekani ka okati ira kina na yalewa, tagane, cauravou, goneyalewa kei ira na gone ni dua na I wase ni tamata, I tokatoka, mataqali se yavusa sara.

ACTIVITY

1. Na cava e dau vakatokai ni sucu na drua;

- a. Tagane - _____
- b. Yalewa - _____
- c. Dua e yalewa ka dua e tagane - _____

2. Na cava beka era dau vakawale gusu kina na gonetagane?

3. Na cava soti tale era qarava na tina e na vanua ko tiko kina me I kuri ni nodra cakacaka e vale?

4. Na cava e vinaka kina ni tukuni me da dolea na veiqaravi ka dredre ni da sauma na dinau ni veiqaravi?

5. Na I tovo cava ko na cakava me vakaraitaka na nomu kauwaitaki tinamu?
