

# **LABASA SANGAM (SKM) COLLEGE**

## **HOMESTUDY PACKAGE 5**

**WORKSHEET NO: 1**

**STUDENTS NAME:** \_\_\_\_\_

**SUBJECT: ACCOUNTING**

**YEAR 11** \_\_\_\_\_

**DUE DATE: 18/10/2021**

**Total marks: 10**

**Weighting: 5%**

### **Instructions :**

- I. Write the answers in the space provided at the back of this page.
- II. File the lesson notes.
- III. Return the **worksheets only** on the due date as stated above.

### **WEEK 13**

1. Explain the purpose of each of the following;

a) Gross profit ratio

---

---

---

b) Mark up ratio

---

---

---

c) Debt to equity ratio

---

---

---

d) Debtors turnover

---

---

---

**(4 marks)**

2. State two limitations of analysis and interpretation of financial statements.

a)

---

---

b)

---

---

---

(2 marks)

**3.** Name two ratios that fall under the category of financial stability ratio .

---

---

(2 marks)

**4.** State two limitations of Ratio Analysis.

i)

---

---

ii)

---

---

(2 marks)

## **LABASA SANGAM (SKM) COLLEGE**

### **HOMESTUDY PACKAGE 5**

WORKSHEET NO: 2

STUDENTS NAME: \_\_\_\_\_

SUBJECT: ACCOUNTING

YEAR 11 \_\_\_\_\_

DUE DATE: 18/10/2021

Total marks: 10

Weighting: 5%

#### **Instructions :**

- I. Write the answers in the space provided at the back of this page.
- II. File the lesson notes.
- III. Return the **worksheets only** on the due date as stated above.

#### **WEEK FOURTEEN**

The following information given below has been extracted from the books of Singh Enterprises for the year ending 30<sup>th</sup> June 2020.

#### **Statement of Financial Performance of Singh Enterprises For The Year Ended 30<sup>th</sup> June 2020**

	\$
Sales (all credit)	90 000
Less cost of goods sold	<u>54 000</u>
Gross profit	36 000
Less operating expenses	<u>10 400</u>
Net profit	<b>25 600</b>

#### **Statement of Financial Position of Singh Enterprises as at 30<sup>th</sup> June 2020**

	\$	\$	\$
Capital at the beginning		28 400	
Add net profit		<u>25 600</u>	
		54 000	
Less drawings		<u>5 300</u>	
<b>Capital at end</b>			<b>48 700</b>
<b>Current asset</b>			
Accounts receivable	26 000		
Inventory	<u>43 600</u>	69 600	
<b>Less current liabilities</b>			
Accounts payable	19 400		
Bank overdraft	<u>10 300</u>	29 700	
<b>Fixed asset</b>			
Equipment (net)		<u>13 900</u>	

		53 800	
<b>Long term liabilities</b>			
Mortgage		5 100	
			<b>48 700</b>

### Additional Information

- a) Opening accounts receivable on 1<sup>st</sup> July 2019 was \$24 000.
- b) The business operates for 300 days in a year.

### Required

Using the information given, calculate the following ratios and percentages (correct to **two decimal places**) for the year ending 30<sup>th</sup> June 2020. **Show the formula and full working.**

	<b>Ratios /percentages</b>	<b>Formula</b>	<b>Working</b>	<b>Answer</b>
(a)	Net profit percentage			
(b)	Mark up percentage			
(c)	Acid test ratio			
(d)	Working capital in dollars			

(e)	Rate of return on owners equity			
(f)	Debt ratio			
(g)	Proprietorship ratio			
(h)	Accounts receivable turnover in days			
(i)	Debt to equity percentage			
(j)	Working capital ratio			

(10 marks)

**FORMATIVE ASSESSMENT TWO**

**SHORT TEST**

**ACCOUNTING**

**YEAR 11**

**TOTAL MARKS: 20**

NAME: \_\_\_\_\_

**Weighting: 20%**

Year 11\_\_

**Due Date: 18/10/21**

**Instructions :**

- I. Write the answers in the space provided.
- II. Return the **short test** on the due date as stated above.

**PART A      MULTIPLE CHOICE**

(5 MARKS)

1. Which of the following indicates the short term financial stability of the business?
  - A. Net profit ratio
  - B. Working capital
  - C. Return on Total assets
  - D. Debtors Turnover

2. Raki's Enterprise's financial position as at 31 December, 2013 was:

Current Assets \$45000	Fixed Assets \$125000
Current Liabilities \$22000	Term Liabilities \$38000
Capital – Sami \$110 000	

From the above information, the Debt to Equity percentage of the business would be:

A. 64.70 %

B. 54.55 %

C. 34.54 %

D. 20.00 %

3. One of the limitations of analysis and interpretation of financial statements is that it

A. allows comparison

B. helps in making decisions

C. is based on historical cost

D. helps to identify strengths and weaknesses

4. The following information concerns a local business as at 30<sup>th</sup> June 2014

Total assets	\$500 000
Non-current assets	\$350 000
Current liabilities	\$50 000
Equity ratio	0.75:1

Calculate the current ratio for the business

A. 0.33:1

B. 0.46:1

C. 2.33:1

D. 3.0:1

5. Young had the following account balances: Sales \$160 000, COGS \$46 000, total expenses \$6 240.

What was his net profit percentage?

A. 63.50%

B. 59.5%

C. 67.35%

D. 28.75%

6. State what each group of ratios listed below measure:

i) Financial Stability ratios

---

---

---

ii) Management Effectiveness ratios

---

---

---

(2 marks)

7. State a ratio that is important in evaluating the short term financial stability of the business.

\_\_\_\_\_ (1 mark)



8. CK's business operates in Suva. Given below is the Statement of Financial Position as at 31<sup>st</sup> October 2014.

	\$	\$	\$
<b>Proprietorship</b>			
Capital – Kaila Yee		100000	
Add Net profit		40000	
Less Drawings		10000	<u>130000</u>
Represented by:			
<b>Assets</b>			
Cash	40000		
Accounts Receivables	35000		
Property & Equipment	125000		
Inventory	10000	<u>210000</u>	
<b>Less liabilities</b>			
Creditors	25000		
Loan ( Payable in 5 yrs)	55000	<u>80000</u>	
			<u>130000</u>

**Additional Information**

1. Sales all credit \$200 000
2. Gross profit \$44 000
3. Opening stock \$38 000
4. Account Receivables 31<sup>st</sup> October 2013 \$33 000

**Required:**

- a) Using the information above, calculate the following ratios and percentages for the year 2014. Show the formula and full working.
  1. Gross profit to sales ratio
  2. Net profit to sales percentage
  3. Acid test ratio
  4. Rate of stock turnover (days)
  5. Accounts Receivable turnover
  6. Working capital in dollars
7. Mark up- ratio
8. Working capital percentage

Ratios /percentages	Formula	Working	Answer
Gross profit to sales ratio			
Net profit to sales percentage			
Acid test ratio			
Rate of stock turnover in days			
Accounts receivable turnover			
Working capital in dollars			
Mark up- ratio			
Working capital percentage			

(12 marks)



**LIVESTOCK PRODUCTION**

**SHORT TEST – YEAR 11**

(Based on Wk13-15 Notes)

NAME: \_\_\_\_\_

(20 MARKS)

1. Describe the features of milk from an udder infected with mastitis. **(1mark)**

---

---

2. Name the structure used to load and unload cattle on trucks. **(1mark)**

---

3. State 4 things to do when preparing animals for slaughter. **(2 marks)**

1 \_\_\_\_\_

2 \_\_\_\_\_

3 \_\_\_\_\_

4 \_\_\_\_\_

4. State one effect of improper exsanguination. **(1mark)**

---

---

5. Name two types of records kept on farms. **(1mark)**

1 \_\_\_\_\_

2 \_\_\_\_\_

6. State **one reason** behind the following practices **(4 marks)**

(a) Castration

---

---

(b) Hoof trimming

---

---

(c) Weaning

---

---

(d) Weighing

---

---

7. Explain **one** reason why animals raised in intensive housing are more **docile** than animals raised in extensive fields. (2 marks)

---

---

---

---

8. Explain **one** reason why Coccidiosis is classified as a serious disease of young animals which are being raised in **pens**. (2 marks)

---

---

---

---

9. Explain **one** reason why farmers castrate male animals which are **very** young. (2 marks)

---

---

---

---

10. Differentiate between a **healthy** and an **unhealthy** farm animal in relation to **vocalisation**. (2 marks)

---

---

---

---

11. The diagram below illustrates the two positions on a hanging sheep carcass which are cut during the process of **sticking** in an abattoir.

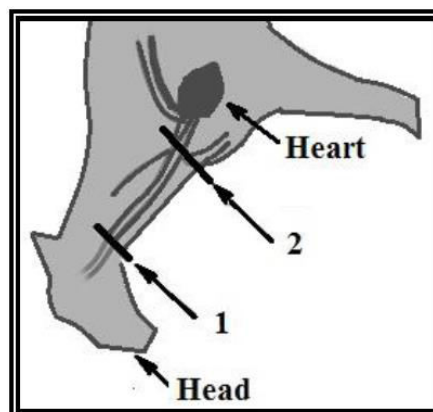

Explain **one** reason why sticking is important. (2 marks)

---

---

---

---

LABASA SANGAM (SKM) COLLEGE

NAME: \_\_\_\_\_

HOME STUDY PACKAGE

YEAR: \_\_\_\_\_

YEAR 11 APPLIED MATHEMATICS

WORKSHEET 1

**Instructions:**

- Write the answers in the space provided.
- **File the lesson notes.**
- Return the **worksheet only**

**Week 13 Activity**

**STRAND 6: TRIGONOMETRY**

**SUB STRAND: TRIGONOMETRIC GRAPHS**

1. A trigonometric graph has the equation  $y = 3 \cos 2\theta$ 
  - a) State the amplitude of this graph. (1 mark)
  - b) What is the period of this graph? (1 mark)
  - c) Sketch the graph for  $0^\circ \leq \theta \leq 360^\circ$  (2 marks)

2. Sketch the graph of the function  $y = -2 \sin 2\theta$  for  $0^\circ \leq \theta \leq 360^\circ$  (2 marks)

3. Solve the following trigonometric equations:

a)  $2 \sin x = 1$  (2 marks)

b)  $2 - \cos \theta = 1$  (2 marks)

**Instructions:**

- Write the answers in the space provided.
- **File the lesson notes.**
- Return the **worksheet only**

**Week 14 & 15 ACTIVITY**

**STRAND 7: STATISTICS**

**SUB STRAND: ANALYSIS AND INTERPRETATION OF STATISTICAL DATA**

1. Seven students sat for a test. Their scores were 100, 50, 45, 40, 80, 75, 45

Find

a) mean (1 mark)

b) median (2 marks)

c) mode (1 mark)

d) range (1 mark)



2. A sample of pebbles was collected from a beach and their weights were recorded. The cumulative frequency graph given below shows the results.

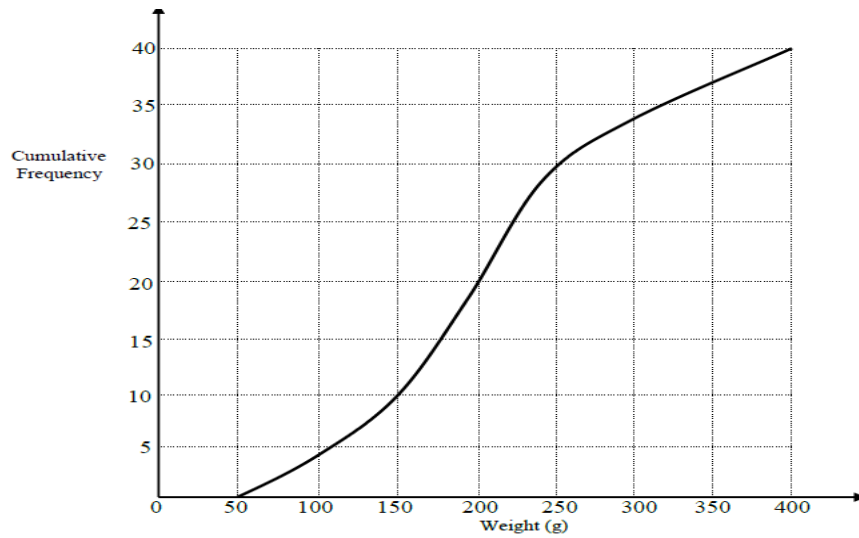

Use the graph to find:

- a) median (1 mark)
- b) inter-quartile range (2 marks)
- c) number of pebbles that weigh more than 150 g. (2 marks)

## SHORT TEST 2

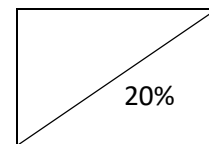

School: Labasa Sangam(SKM) College  
Subject: Applied Technology  
Worksheet Number: 1-2 / Week 15

Year/Level: 11 C/D/E  
Student Name: \_\_\_\_\_  
Date: 13<sup>th</sup> October 2021

Duration: 1 Hour.

Due date 18<sup>th</sup> October 2021

### Question 1 (10 marks)

- a) Define the following terms given below in your own words  
Elements of Design

---

---

---

(1 ½ marks)

- b) Define shape

---

---

---

(1 ½ mark)

- c) Label the parts of arc welding given below

(4 marks)

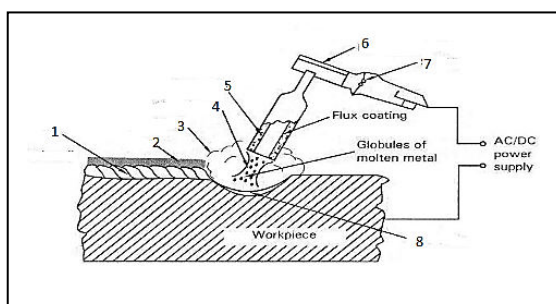

1. \_\_\_\_\_
2. \_\_\_\_\_
3. \_\_\_\_\_
4. \_\_\_\_\_
5. \_\_\_\_\_
6. \_\_\_\_\_
7. \_\_\_\_\_
8. \_\_\_\_\_

- d) What does the following safety symbols mean?



1. \_\_\_\_\_ 2. \_\_\_\_\_ 3. \_\_\_\_\_
4. \_\_\_\_\_ 5. \_\_\_\_\_ 6. \_\_\_\_\_

(3maks)

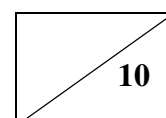

**Question 2 (10 marks)**

**a) List 7 reasons why is health and safety important in the workshop?**

- a) \_\_\_\_\_
- b) \_\_\_\_\_
- c) \_\_\_\_\_
- d) \_\_\_\_\_
- e) \_\_\_\_\_
- f) \_\_\_\_\_
- g) \_\_\_\_\_

**(7marks)**

**b) Make a safety notice for on how you should lift a box from the floor to the work bench?**

**(3marks)**

LABASA SANGAM COLLEGEYEAR 11 BIOLOGY-2021SHORT TEST 2 ( 20 MARKS)

NAME : \_\_\_\_\_ YEAR \_\_\_\_\_

## Short answer questions

1. A species of frog lays a lot of eggs and provides no significant parental care. Draw the survivorship curve for the this frog population and label it (2 marks)

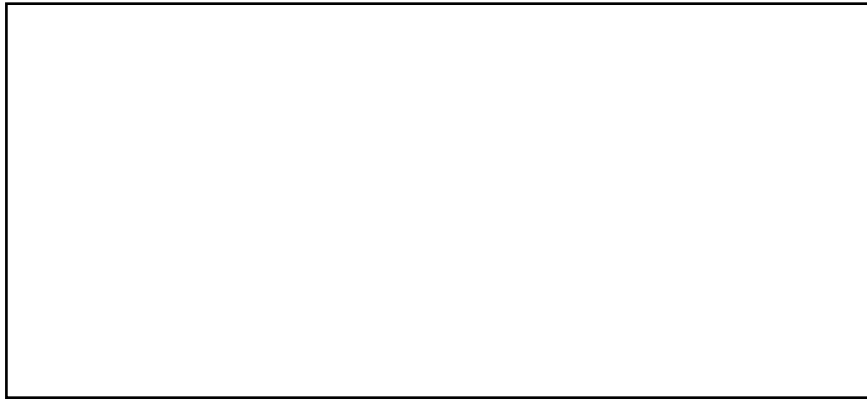

- i. Briefly explain why the human survivorship curve would differ from that of the frog population. (2marks)

---

---

---

2. Define non communicable disease and give 1 example (2 marks)

---

---

3. Using the mark-recapture method, the population size of wild cats on Lomawai Island was estimated to be 280. The area of the Island is 10 km<sup>2</sup>.

(i) Calculate the population density of wild cats on Lomawai Island. (2marks)

---



---



---

4. Define malnutrition. (1 mark)

---



---

5. Give 2 difference the difference between Marasmus and Kwashiorkor. (2marks)

---



---

6. Complete the table on essential minerals given below (6 marks)

Mineral	Function	Food source	Deficiency
Calcium	(i)	Dairy products	(ii)
Iodine	For production of Thyroxin.	(iii)	(iv)
Iron	(v)	(iv)	Anaemia – lack of haemoglobin/ red blood cells

7. Describe three factors that contribute to the rapid spread of HIV AIDS virus (3marks)

---



---

The end 😊

# LABASA SANGAM (SKM) COLLEGE

## SHORT TEST BATCH 5

### YEAR 11 CHEMISTRY 2021

NAME: \_\_\_\_\_

YEAR: \_\_\_\_\_

(20 MARKS)

Duration: 1 Week Due Date: 18/10/21

#### Question 1

What is an **alloy**? Provide **one example** of an alloy.

**Definition:** \_\_\_\_\_ (1 mark)

**Example:** \_\_\_\_\_ (1 mark)

#### Question 2

Describe **copper deficiency**.

\_\_\_\_\_  
\_\_\_\_\_ (2 marks)

#### Question 3

From the following list, **choose a metal(s)** that is appropriate for each use given below.

Give **reasons** for your choice.

Aluminium	Lead	Copper	Duralumin
-----------	------	--------	-----------

- (i) Making a **cooking pot**.

**Metal:** \_\_\_\_\_ (1 mark)

**Reason:** \_\_\_\_\_ (1 mark)

(ii) Making **electrical wires**.

**Metal:** \_\_\_\_\_ (1 mark)

**Reason:** \_\_\_\_\_ (1 mark)

(iii) Building an **aeroplane**.

**Metal:** \_\_\_\_\_ (1 mark)

**Reason:** \_\_\_\_\_ (1 mark)

(iv) Weights for **fishing net**.

**Metal:** \_\_\_\_\_ (1 mark)

**Reason:** \_\_\_\_\_ (1 mark)

#### **Question 4**

Name 2 non-metals.

1. \_\_\_\_\_

2. \_\_\_\_\_

(2 marks)

#### **Question 5**

What is plastic sulphur and **explain** how plastic sulphur is made.

**Definition:** \_\_\_\_\_ (1 mark)

**Explanation:**

\_\_\_\_\_  
\_\_\_\_\_ (1 mark)

#### **Question 6**

Non-metals oxides are acidic in nature because they react with water to form acidic solutions.

Using the information given above **complete the equation** given below.

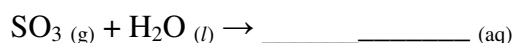

(1 mark)

**Question 7**

Give the **equation** for the preparation of sulphur dioxide gas.

\_\_\_\_\_ (1 mark)

**Question 8**

Give the **general formula** for alkanes.

(1 mark)

**Question 9**

**Define** fractional distillation.

\_\_\_\_\_  
\_\_\_\_\_ (1 mark)

**\*\*\*THE END \*\*\***



**LABASA SANGAM (SKM) COLLEGE**  
**YEAR 11 ECONOMICS WORKSHEET**  
**HOME STUDY PACKAGE-5**

**Worksheet Number :1**

**Name of the Student:** \_\_\_\_\_

**Due Date: 27<sup>th</sup> September,2021**

**Year:** \_\_\_\_\_

1. Define Free trade.

---

---

---

(1mark)

2.State two advantages of free trade.

---

---

---

---

(2marks)

3.State two disadvantages of free trade.

---

---

---

---

(2marks)

4. Define Protection.

---

---

---

(1mark)

5. State two reasons for protection

---

---

---

---

---

(2marks)

6. State two effects for protection

---

---

---

---

---

(2marks)

**LABASA SANGAM (SKM) COLLEGE**

## **YEAR 11 ECONOMICS WORKSHEET**

## HOME STUDY PACKAGE-5

## Worksheet Number :2

**Name of the Student:** \_\_\_\_\_

**Due Date: 27<sup>th</sup> September, 2021**

**Year:** \_\_\_\_\_

## Question

*“while developing countries like Fiji is enjoying benefits from free trade , they also need some form of protection”.*

With reference to the above statement ,discuss:

- **Three** forms of protectionism.
- **Three** reasons in favour of protectionism.
- **Three** arguments against protectionism if Fiji is ever to compete with developed countries.

This image shows a full page of white paper with horizontal blue ruling lines. The lines are evenly spaced and run across the width of the page, providing a template for handwriting practice or general writing. There are no margins, text, or other markings on the page.

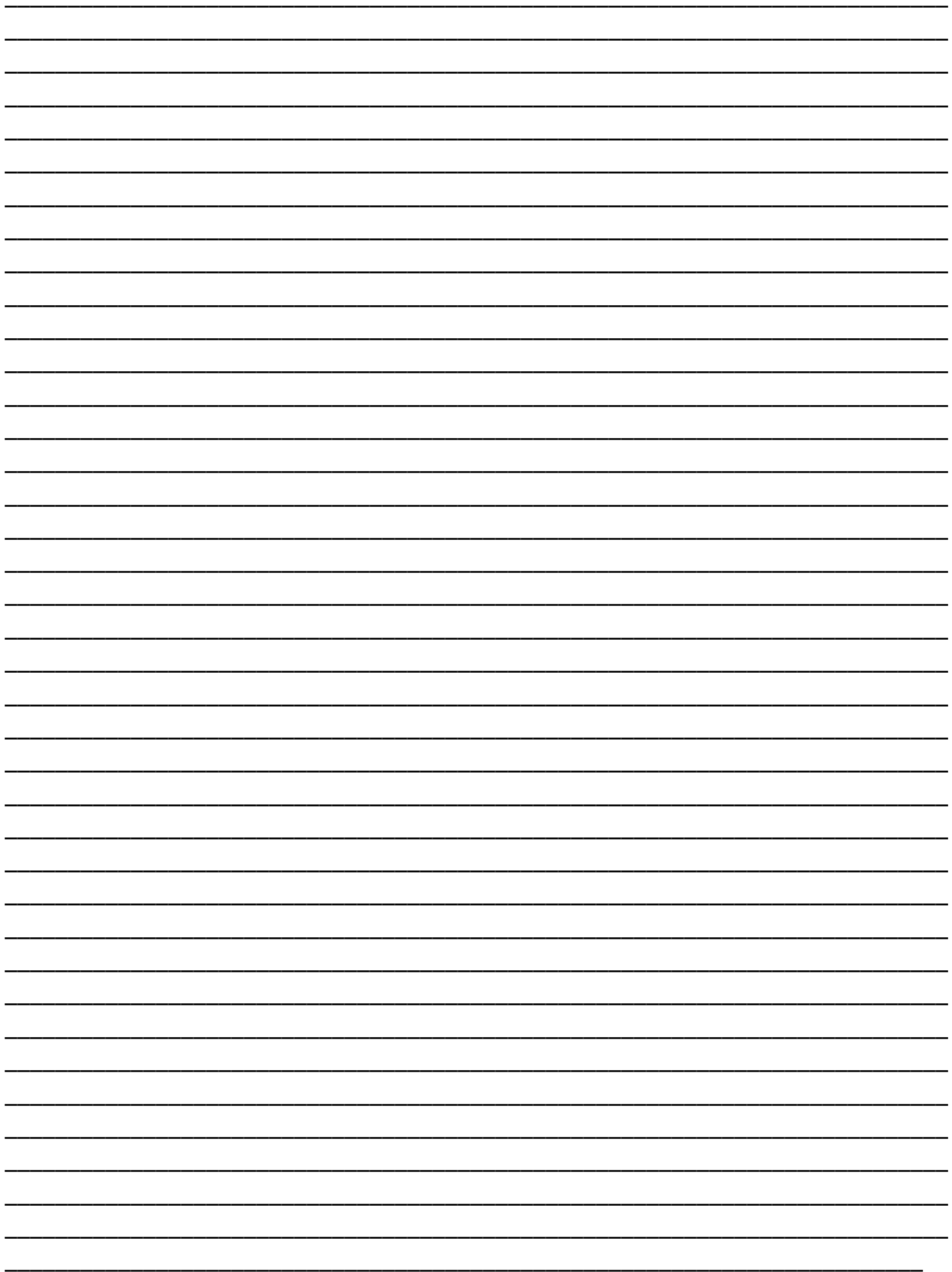

NAME: \_\_\_\_\_

YEAR 11\_\_\_\_\_

**LABASA SANGAM (SKM) COLLEGE**  
**YEAR 11 GEOGRAPHY HOME STUDY PACKAGE**  
**TOPIC 4: VEGETATION**  
**WEEK 10,11 &12**

1. What is vegetation? (10 Marks)

\_\_\_\_\_  
\_\_\_\_\_ (1 mark)

2. Differentiate between **native plants** and **exotic plants** with **examples**

\_\_\_\_\_  
\_\_\_\_\_ (2 marks)

3. List 4 important functions of vegetation in the ecosystem

\_\_\_\_\_  
\_\_\_\_\_  
\_\_\_\_\_  
\_\_\_\_\_ (2 marks)

4. Name 3 native trees and 3 exotic trees in Fiji

\_\_\_\_\_  
\_\_\_\_\_  
\_\_\_\_\_ (2 marks)

5. Name 3 factors that affect vegetation distribution

\_\_\_\_\_  
\_\_\_\_\_  
\_\_\_\_\_ (2 marks)

6. Name the 5 types of vegetation regions

\_\_\_\_\_  
\_\_\_\_\_ (1 mark)

**...THE END...**

NAME: \_\_\_\_\_

YEAR 11\_\_\_\_\_

**LABASA SANGAM (SKM) COLLEGE**  
**YEAR 11 GEOGRAPHY HOME STUDY PACKAGE**

**TOPIC 4: VEGETATION**

**WEEK 10,11 &12**

**(10%)**

1. Discuss how the altitude and latitude affects vegetation distribution

\_\_\_\_\_  
\_\_\_\_\_ (1 mark)

2. Explain the relationship between **precipitation** and **vegetation**

\_\_\_\_\_  
\_\_\_\_\_ (1 mark)

3. List 3 characteristics of a tropical rainforest

\_\_\_\_\_  
\_\_\_\_\_ (2 marks)

4. Where will you find tundra forest? State one of its features

\_\_\_\_\_  
\_\_\_\_\_ (2mark)

5. Name 3 characteristic of coniferous forest

\_\_\_\_\_  
\_\_\_\_\_ (2 marks)

**6. Definitions**

- a. Canopy -

\_\_\_\_\_  
\_\_\_\_\_ (1 mark)

- b. Epiphytes -

\_\_\_\_\_  
\_\_\_\_\_ (1 mark)

**THE END**









-----  
-----  
३. संसार में मनुष्य को मोक्ष की प्राप्ति कैसे मिलता है ? (अंक १ )

-----  
-----  
४ स्वर्ग और नरक पर चर्चा कीजिए ।

-----  
-----  
-----  
-----  
(अंक २ )

LABASA SANGAM [SKM] COLLEGE

YEAR 11 HISTORY ASSESSMENT - SHORT TEST

WORKSHEET 15

GOVERNMENT AND GOVERNANCE: UNIT 1-6

SECTION A: RESOURCE INTERPRETATION

(20 Marks)

Use your knowledge of the topic to answer the questions that follow. Each question is worth two marks each. Use the **Four Resources** and your knowledge to answer the questions that are given. Write 1-3 sentences.

Resource I

(6 marks)

The co-existence of the administration systems started all the way back during the colonial period and continues into the present period. Sir Arthur Gordon was trying to preserve the *i-Taukei* way of life through indirect rule and at the same time slowly introducing the Parliamentary system. This dual administration allowed the British to rule Fiji without interfering so much with the traditional leadership structure.

Source: *Government and Governance*, Ministry of Education, 2012

- i. Name one of the two systems that co-existed in Fiji from 1886 to 2006. (2 marks)

---

---

---

---

---

---

- ii. Describe the role of the Great Council of Chiefs in this Dual Administration. **(2 marks)**

---

---

---

---

---

---

- iii. Explain a way in which the dual administration preserved traditional leadership structure. **(2 marks)**

---

---

---

---

---

---



- i. Name the piece of paper that the voter is putting inside the box? (2 marks)

---

---

---

---

---

---

- ii. State a reason why is it important to have an Officer supervising the voters. (2 marks)

---

---

---

---

---

---

iii. Explain the reason why voting takes place in an enclosed area. (2 marks)

---

---

---

---

---

---

Resource III (6 marks)



Source: *Government and Governance*, Ministry of Education, 2012

- i. State a kind of presentation lawyers would do in the Court Room **(2 mark)**

---

---

---

---

---

---

- ii. Define the term client in relation to a trial process. **(2 marks)**

---

---

---

---

---

---

- iii. Explain the significance of research before the trials for lawyers. **(2 marks)**

---

---

---

---

---

---

**Resource IV**

**(2 marks)**

A year after the election, Dr Ahmed Ali concluded that “the 1972 General Election confirms the past pattern of political behavior”. (Ali, *Journal of Pacific History*, 1973, p.180) Communal loyalty was strong and each community remembered the struggles over the 1960 sugar strike and the bitter debates in the 1960s over a proposed common roll of voters. The Alliance continued to support the policies of the former British rulers and its supporters dominated the Great Council of Chiefs. Dr Ali concluded that this situation was unlikely to change.

Source: *Government and Governance*, Ministry of Education, 2012.

- i. State the past pattern of political behavior that Dr. Ali is referring to in the article.

**(1 mark)**

---

---

---

---

---

---

- ii. Explain a reason why Dr. Ali’s prediction in the last sentence is inaccurate. **(1 mark)**

---

---

---

---

---

**THE END**



**LABASA SANGAM (SKM) COLLEGE**

**HOME ECONOMICS**

**Name:** \_\_\_\_\_

**Year: 11** \_\_\_\_\_

**TOTAL MARKS: 10**

**WEIGHTING :5 %**

**NOTE:**

- 1. Write all your answers in the space provided.*
- 2. Always use your text book for reference.*
- 3. Return the completed worksheet on the 18<sup>th</sup> of October 2021(Worksheets 10- 12)*
- 4. For further enquires, do not hesitate to ask me and write your name on every page.*
- 5. There is no need for you to rewrite the summarised notes. File them properly and neatly.*

**WORKSHEET 13**

1. Name any **two** types of fasteners

\_\_\_\_\_

(1 mark)

2. Define the term **Fasteners**

\_\_\_\_\_  
\_\_\_\_\_  
\_\_\_\_\_

(1 mark)

3. State **two** points to consider when selecting a garment with a zip.

(i) \_\_\_\_\_

\_\_\_\_\_

(ii) \_\_\_\_\_

\_\_\_\_\_

(2 marks)

4. State **two** tips on how to take care of the zip

(i) \_\_\_\_\_

\_\_\_\_\_

(ii) \_\_\_\_\_  
\_\_\_\_\_  
(2 marks)

5. A nylon fastener consists of **two** parts. Name those parts.

(i) \_\_\_\_\_ (ii) \_\_\_\_\_  
(1 mark)

6. Explain any **three** rules for sewing on buttons.

(i) \_\_\_\_\_  
\_\_\_\_\_  
(ii) \_\_\_\_\_  
\_\_\_\_\_  
(iii) \_\_\_\_\_  
\_\_\_\_\_  
(3 marks)

### **WORKSHEET 14**

1. Explain the purpose of a shank.

\_\_\_\_\_  
\_\_\_\_\_  
(1 mark)

2. Identify and explain the techniques shown below

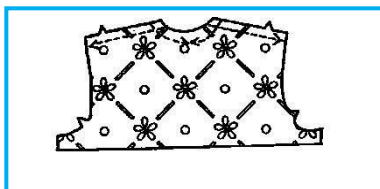

\_\_\_\_\_  
\_\_\_\_\_  
\_\_\_\_\_

(ii)

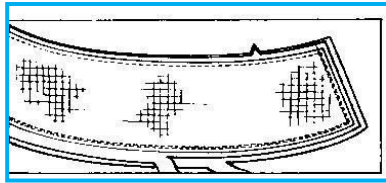

---

---

---

(iii)

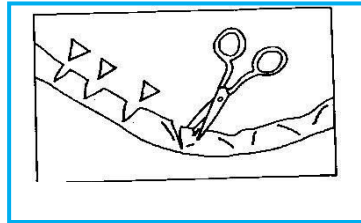

---

---

---

(6 marks)

3. Name the **three** types of seams

(i) \_\_\_\_\_

(ii) \_\_\_\_\_

(iii) \_\_\_\_\_

(3 marks)

**SHORT TEST**  
**HOME ECONOMICS**

**Name:** \_\_\_\_\_

**Year:** 11\_\_\_\_\_

**TOTAL MARKS: 20**

**WEIGHTING :20 %**

**NOTE:**

- 1. Write all your answers in the space provided.*
- 2. You may use your text book for reference.*
- 3. Return the completed worksheet on the 18<sup>TH</sup> of October 2021 with Worksheets 13- and 15*
- 4. For further enquires, do not hesitate to ask me and write your name on every page.*
- 5. This open book test is based on Strand 3 – the notes that we have covered so far.*

1. Explain the function of a care label.

---

---

(1 mark)

2. Write any **three** methods of straightening the fabric

(i) \_\_\_\_\_

---

(ii) \_\_\_\_\_

---

(iii) \_\_\_\_\_

---

(3 marks)

3. Explain the function of mordant in tie dyeing and give an example of mordant.

---

---

(1 mark)

4. State the function of the following parts of a sewing machine.

i) Bobbin winder \_\_\_\_\_  
\_\_\_\_\_

ii) Feed dog \_\_\_\_\_  
\_\_\_\_\_

(2 marks)

5. Identify the **two** traditional Fijian artefacts that are still prepared by the I- Taukei.

(i) \_\_\_\_\_

(ii) \_\_\_\_\_

(2 marks)

6. State the use of the following types of sewing machines:

(i) Over locker \_\_\_\_\_  
\_\_\_\_\_

(1 mark)

(ii) Treadle sewing machine \_\_\_\_\_  
\_\_\_\_\_

(1 mark)

6. Explain the function of a **buttonholer**.

\_\_\_\_\_  
\_\_\_\_\_

(1 mark)

7. Study the picture below and answer the following questions.

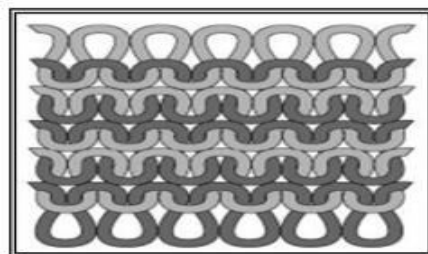

Source: Year 11 Home Economics  
Textbook

(i) Identify the type of knitting illustrated in the picture.

\_\_\_\_\_  
(1 mark)

(ii) State **two** properties of knitted fabrics that make it a popular wear.

1. \_\_\_\_\_

2. \_\_\_\_\_

(2 marks)

8. Sewing machines need regular oiling.

(i) Explain the purpose of oiling sewing machines.

\_\_\_\_\_

\_\_\_\_\_

(1 mark)

(ii) Why is it important to run the machine after oiling on scraps of material prior to the actual sewing? \_\_\_\_\_

\_\_\_\_\_

(1 mark)

9. Alterations have been made to the sleeve pattern shown below.

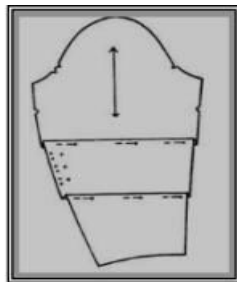

Source: Year 11 Home Economics Textbook

(i) Describe the procedure used in altering the sleeve pattern above.

\_\_\_\_\_

\_\_\_\_\_

\_\_\_\_\_

\_\_\_\_\_

(2 marks)

(c) French seams are considered to be strong seams.

Name one garment where the French seam is most useful.

\_\_\_\_\_

(1 mark)

NAME:

YEAR 11:

**YEAR 11 MATHEMATICS LIFE SKILLS****SHORT TEST (WEEK 15)****STRAND 4: Trigonometry in Everyday Context**

(TIME ALLOWED: 45 MINUTES)

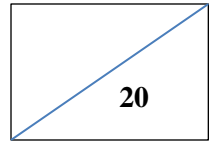

1. A clothes line is to be hung across a garden shown below. How long should it be?

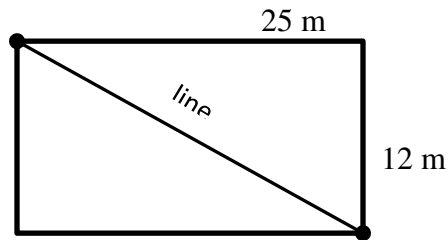

(1 mark)

2. A ramp is 4m long with a horizontal base of 2m. What is the height of the ramp?

(1 mark)

3. A garden is in a shape of a right angle triangle.

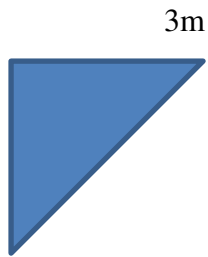

- a) Find the perimeter of the garden.

(1 mark)

- b) If posts are placed 1 m for fencing the garden, how many posts will be needed?

(1 mark)



4. A cyclist travels 15km due north and then 18 km due east. How far is she from the starting point?

(1 mark)

5. A diagonal brace is made for a door frame 2m by 1m. What is the length of the brace?

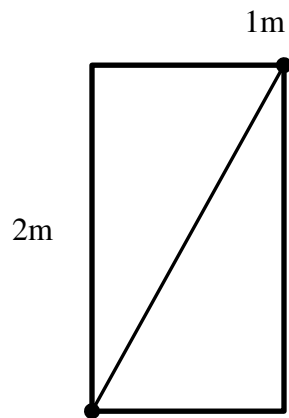

(1 mark)

6. A boat sails 2 km South and then 4 km east. How far is the boat from the starting point?

(1 mark)

7. The following is a building sketch of single-storey house

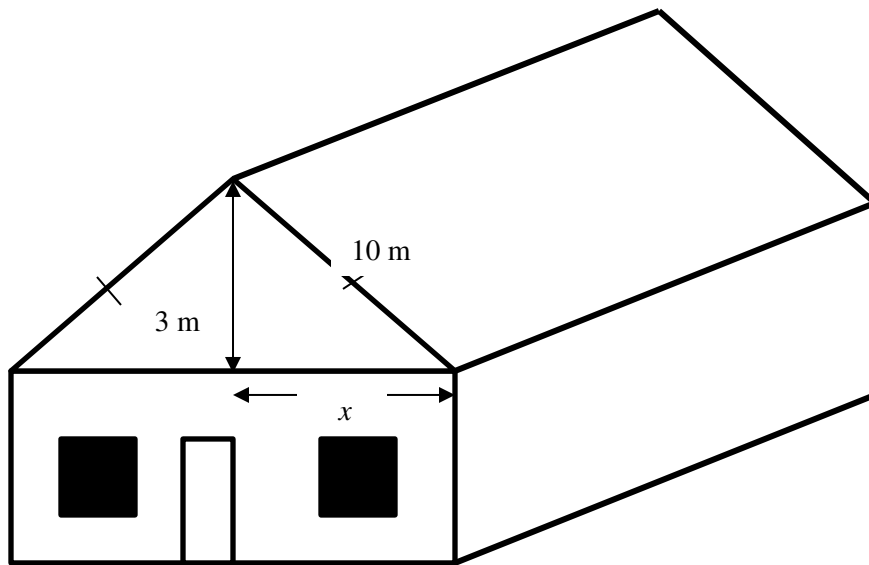

- a) Find  $x$

(1 mark)

b) What is the width of the house?

(1 mark)

8. A swimmer starts to cross a 20m wide river. The current carries her 8m downstream from the original landing place. How much further has she had to swim than the width of the river?

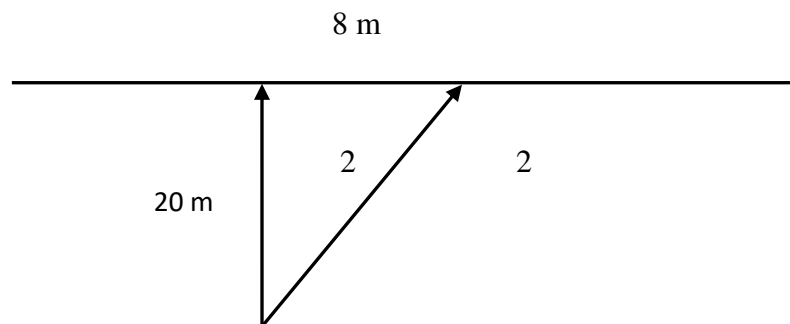

(2 marks)

9. A 5m ladder is leaning against a wall. The foot of the ladder is 3 m from the base of the wall.

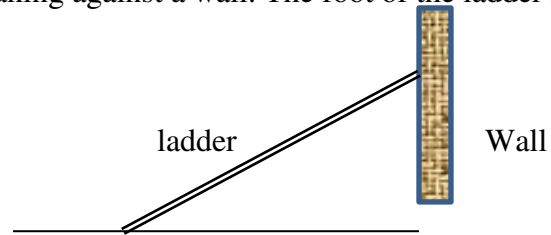

What angle does the ladder make with the ground?

(1 mark)

10. Determine the length of the roofing beam,  $l$ , required to support a roof of pitch  $20^\circ$  as shown in the diagram.

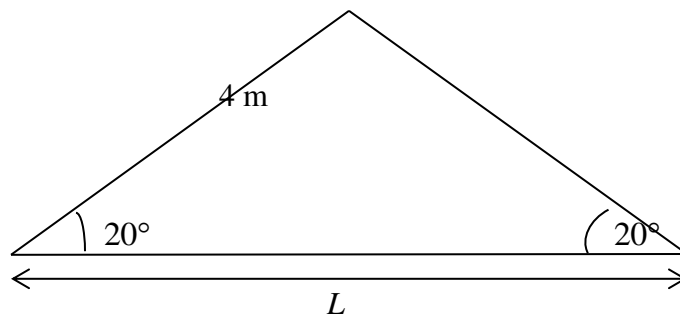

(3 marks)

11. The top of a tree, when viewed 20 m from the base of the tree, has an angle of elevation of  $45^\circ$ . Find the height of the tree.

(1 mark)

12. A tree 6m high casts a shadow 4m long. What angle do the sun's rays make with the ground?

(1 mark)

13. Calculate the angle of pitch ( $\theta$ ) of a roof truss 5m wide and 1.3 m high

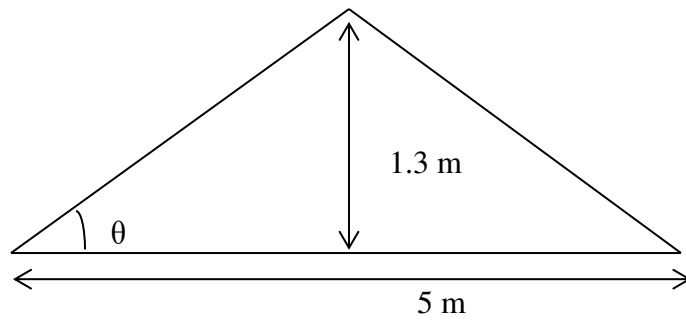

(3 marks)

The End

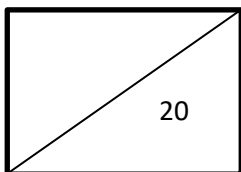

Name: \_\_\_\_\_  
Year: \_\_\_\_\_

**LABASA SANGAM (SKM) COLLEGE**  
**HOME STUDY PACKAGE**  
**YEAR 11 PHYSICS**  
**SHORT TEST 2**

1. Photovoltaic energy is the conversion of sunlight into
  - A. chemical energy
  - B. biogas
  - C. electricity
  - D. Geothermal energy(1 mark)
  
2. A moving object always possesses
  - A. potential energy
  - B. thermal energy
  - C. kinetic energy
  - D. magnetic energy(1 mark)
  
3. What is the purpose of having cylindrical water towers above ground or water tanks at the top of buildings?
  - A. To increase the height, hence increasing the water pressure in homes.
  - B. To increase the volume of water, thereby increasing the water pressure in homes.
  - C. To displace water so less water is placed behind large dams in reservoirs.
  - D. To store water for use by consumers.(1 mark)
  
4. The temperature of a solid body is defined as the
  - A. Thermal energy required to increase the body's temperature by one degree
  - B. Maximum thermal energy that must be supplied to meet the solid
  - C. Total kinetic and potential energy of the solid's molecules
  - D. Average kinetic energy of the solid's molecules(1 mark)
  
5. State the law of conservation of energy.  
\_\_\_\_\_  
\_\_\_\_\_  
\_\_\_\_\_  
\_\_\_\_\_ (1 mark)

6. The small piston of a hydraulic lift has a cross-sectional area of  $0.005 \text{ m}^2$ , and its large piston has a cross-sectional area of  $0.04 \text{ m}^2$ . What downward force must be applied to the small piston for the lift to raise a load of  $15 \text{ kN}$ ?

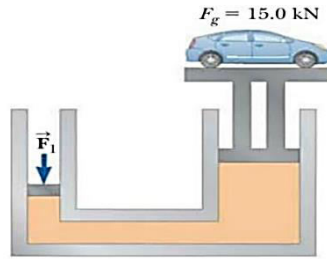

---

---

---

---

---

---

---

---

(2 marks)

7. What is the pressure  $80 \text{ m}$  below the surface of sea water? (Density =  $1150 \text{ kg/m}^3$ )

---

---

---

---

---

---

---

---

(2 marks)

8. An object weighs  $35 \text{ N}$  in air and  $25 \text{ N}$  when immersed in water. The density of water is  $1000 \text{ kg/m}^3$ . Find;

i) the upthrust applied by water.

---

---

(1 mark)

ii) the weight of water displaced.

---

---

(1 mark)

iii) the mass of water displaced.

---

---

---

---

(1 mark)

iv) the volume of water displaced

---

---

---

---

(1 mark)



9. A piece of aluminium of mass 0.400 kg at 100 °C is lowered into a 0.500 kg of water at 10 °C. The resulting temperature of the mixture is 23 °C. Assume that there are no heat losses. Specific heat capacity of water is 4200 J/kg/°C.

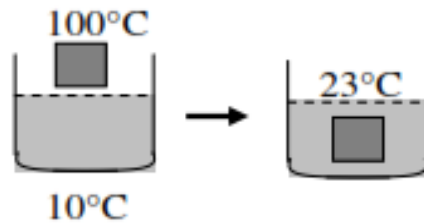

- i) heat gained by water.

\_\_\_\_\_  
\_\_\_\_\_  
\_\_\_\_\_ (1 mark)

- ii) specific heat capacity of aluminium.

\_\_\_\_\_  
\_\_\_\_\_  
\_\_\_\_\_  
\_\_\_\_\_ (2 marks)

10. Explain the use of a compressor in a refrigerator.

\_\_\_\_\_  
\_\_\_\_\_  
\_\_\_\_\_ (1 mark)

11. Differentiate between conduction and convection form of heat transfer.

\_\_\_\_\_  
\_\_\_\_\_  
\_\_\_\_\_  
\_\_\_\_\_ (2 marks)

12. The specific latent heat of fusion of ice is 336 000 Jkg<sup>-1</sup>. What is the quantity of heat required to melt 3.5 kg of ice at 0 °C?

\_\_\_\_\_  
\_\_\_\_\_  
\_\_\_\_\_  
\_\_\_\_\_  
\_\_\_\_\_ (1 mark)

**THE END**

SHORT TEST-2

NAME: \_\_\_\_\_

YEAR: \_\_\_\_\_

School: Labasa Sangam(SKM) College  
Subject: Technical drawing  
Week:15/worksheet:1

Year/Level:11C/D/E  
Due Date:18<sup>th</sup> October 2021  
Date:13<sup>th</sup> October 2021

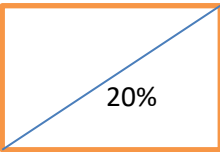

QUESTION:1

Design

(20 marks)

Problem:

School children find it difficult to study when their homes are small or overcrowded.

Brief:

Design an **OUTDOOR STUDY TABLE** to be used by school children at home.

Specification:

The OUTDOOR STUDY TABLE should:

- (a) Be portable and folded for easy storage.
- (b) Have two seats fixed together with the frame while sitting.
- (c) Accommodate at least 6 people.
- (d) Be made from a combination of an appropriate metal, wood and plastic.

Requirements:

- (a) Produce two freehand pictorial sketches of the **OUTDOOR STUDY TABLE** (8 marks)
- (b) Evaluate each sketch on the following criteria:
  - (i) materials used
  - (ii) Safety (4 marks)
- (c) Explain with the help of sketches how the parts are assembled. (3 marks)
- (d) Draw a pencil-rendered or a colour-rendered pictorial sketch of the final solution. (5 marks)

**[20 marks]**

20

[illegible]